

Product Description

1. API 682 Category 2 and 3, Type A, Arrangement 2 seal
2. Dual seal in face-to-back configuration
3. Balanced design
4. Non contact outer seal (containment seal)
5. Cartridge construction
6. Rotating unit with multiple springs

Technical Features

1. Suitable for both, retrofits and original equipment
2. Varied selection of materials available
3. Safe operation due to metal torque transmission at the rotating carbon seal rings

Industrial Application

- API 610/ISO 13709 pumps
- Media with gaseous leakage
- Oil and gas industry
- Petrochemical industry
- Refining technology
- Process pumps

Operating Limits

Shaft diameter: : d1 = 20 ... 110mm

Pressure: p1 = ... 42 (609) bar

Temperature: t = -40 °C ... +176°C

Sliding velocity: vg = 23 m/s

Axial movement = ±1.0mm

Note : Other Sizes On Request

Material Of Construction

Seal rings: Blister resistant carbon, Silicon carbide SSiC , RBSiC

Mating rings: Silicon carbide SSiC (Q1), RBSiC (Q2)

Secondary seals: EPDM (E), NBR (P), FKM (V), FFKM (K)

Springs: : Hastelloy® C-276 (M5)

Metal parts: CrNiMo steel 316 (G) or equivalent, optional materials on request.

Note : Other MOC Combinations On Request

Recommended Piping plans-2CW-CS

Process side: 01, 02, 03, 11, 12, 13, 14, 21, 22, 23, 31, 32, 41

Between seals: 71, 72, 75, 76

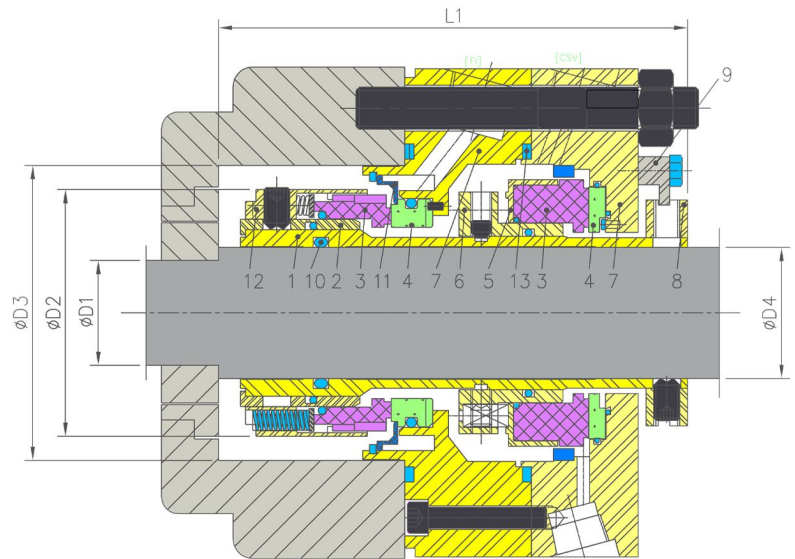

Item	Description
1	Sleeve
2	Aux Sleeve
3	Seal ring
4	Mr (ib& Ob)
5	Shell
6,12	Cup
7	Gland
8	Drive Collar
9	Locking plate
10	O ring
11	Retaining ring
13	Gasket