

RXHH-RXHH-BB

API 682 4th Edition Category 2 & 3
Seal type C (Rotating)
Configuration 3CW-BB (Contacting Wet - Back-to-Back)

Product Description

1. API 682 Category 2 and 3, Type C, Arrangement 2 & 3 seal
2. Dual seal in face-to-back configuration
3. Balanced design
4. Independent of direction of rotation
5. Cartridge construction
6. For plain shafts
7. Rotary metal bellows design
8. Shrink fitted seal rings and solid mating rings

Technical Features

1. Suitable for high and low temperature application
2. Compact design
3. No dynamically loaded O-ring which reduces chances of seal face hang-up.
4. Pumping screw for media with higher viscosity also available
5. Short installation length possible
6. Rugged design for long operating life
7. Bellows design efficiently ensure self-cleaning
8. Bellows design minimizes variation in face load due to shaft expansion or face wear
9. Resistant to abrasive particles in the medium, no shaft or sleeve fretting

Industrial Application

- API 610/ISO 13709 pumps
- Chemical & Petrochemical industry
- Cold media
- Highly viscous media
- Hot media
- Power plant
- technology
- Refining technology
- Oil and gas industry
- Power plant technology
- LPG plants
- Process pumps

Operating Limits

Shaft diameter: : d1 = 20 ... 110 mm

Pressure: p1 = ... 25 bar

Temperature: t = -75 °C ... +400 °C

Sliding velocity: vg == 23 m/s

Note: Other Sizes On Request

Material Of Construction

Seal rings: Blister resistant carbon

Mating rings: Silicon carbide SSiC, RBSiC

Bellows: Hastelloy® C-276 ,

Option: Inconel® 718

Secondary seals: Graphite

Metal parts: CrNiMo steel 316

Carpenter® 42 (T4)

Note: Other MOC Combinations On Request

Recommended Piping plans-3CW- BB

Process side: 01, 02, 03, 11, 12, 13, 14, 21, 22, 31, 32, 41

Between seals: 53A, 53B, 53C, 54

Atmospheric side*: 61, 62, 65A, 65B

* Throttle bushing on request

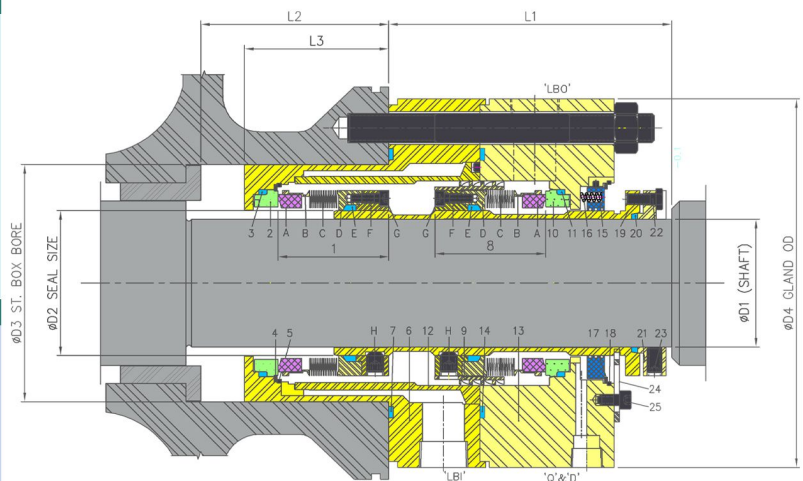

Item	Description
1,8	Rotary head
2,10	Mr (Ib & Ob)
3,11	Mr Gasket
4,17	Retaining ring
5,18	Circlip
6,13	Gland (Ib & Ob)
7,14,20	Gasket
9	Pumping Screw
12	Inner ring
15	Floting Bush
16	Springs
17	Retaining ring
19	Sleeve
21	Hex Bolts
23	Soc Set Screw
24	Sliding Washer
25	Soc Head Screw