

Product Description

1. Double seal configuration
2. Balanced Design
3. Independent of Direction of Rotation.
4. Cartridge Design construction
5. Inside mounted
6. Multi spring rotation

Technical Features

1. Ideal for use in ANSI process pumps
2. Cartridge unit factory assembled for easy installation
3. Rugged design for long operating life
4. Ideal to convert and retrofit pumps with packing's and large OEM production

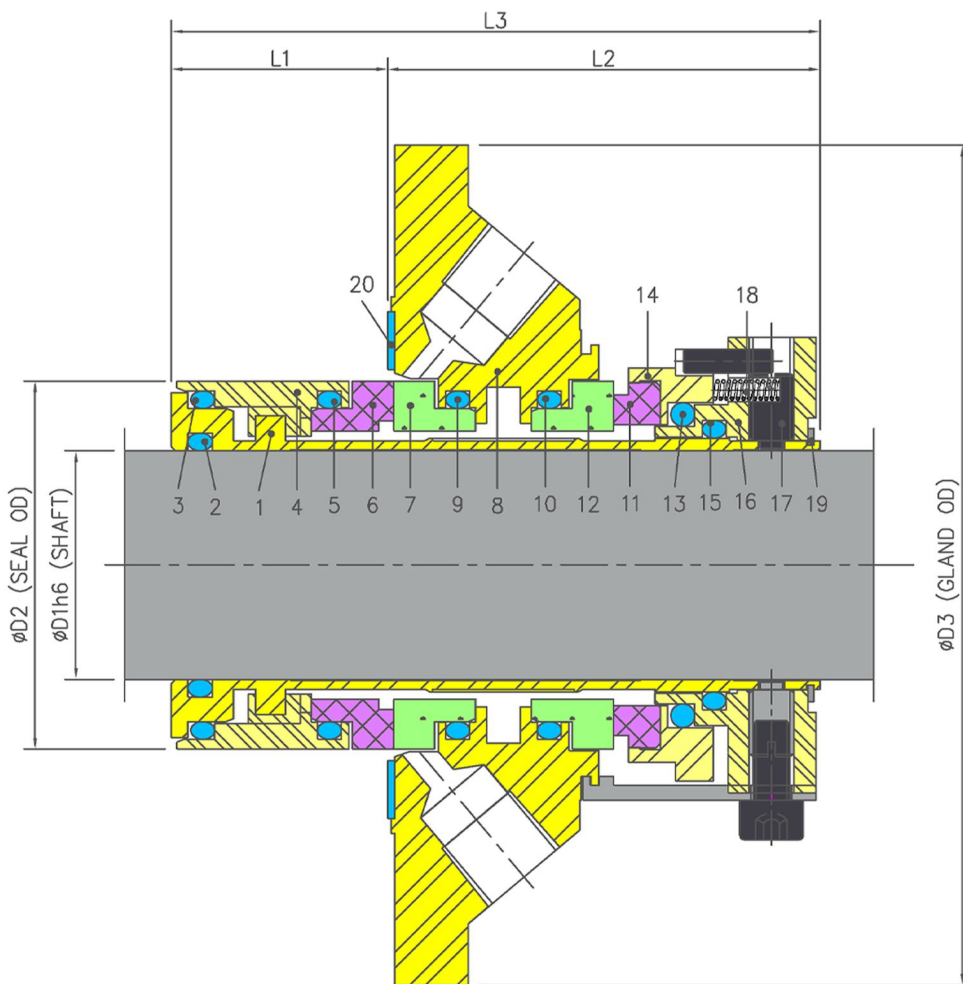

Industrial Application

ANSI process pumps
 Chemical Industry
 Food and beverage industry
 Petro-chemical Industry
 Pharmaceutical Industry
 Water and waste water technology

Material Of Construction

Seal Face : Carbon Graphite Antimony Impregnated / Carbo Graphite Resin Impregnated / Silicon Carbide / Tungsten-Carbide
Seat : Carbon Graphite Antimony Impregnated / Carbon Graphite Resin Impregnated / Silicon-Carbide/ Tungsten-Carbide
Elastomer : Viton/Aflas /TTV/EPDM/KARLEZ
Metal Parts : S.S.316 / Hast'C

Note : Other MOC Combinations On Request

Available Sizes

25mm to 100mm (1.000" to 4.000")

Note : Other Sizes On Request

Operating Limits

Pressure = 25 Kg/cm2 (MAX)
Temperature = -40°C to 220°C
Speed = 16 m/s
Permissible axial movement =
 d1 upto 100mm = ± 0.5 mm
 d1 from 100mm = ± 2.0 mm

Item	Description
1	Sleeve
2,3,5,9,10,13,15	O Ring
4,14	SR IB&OB Shell
6,11	SR IB&OB
7,12	MR IB&OB
8	Gland plate

Item	Description
16	Drive Collar
17	Set Screw
18	Spring
19	Circlip
20	Gasket

Dimensional Data

D1								
INCH	MM	D2	D3	D4	L1	L2	L3	L4
0.875	22.00	40.73	104.78	60.33	29.00	58.00	87.00	12.00
1.000	25.00	43.93	104.78	60.33	29.00	58.00	87.00	12.00
1.125	28.00	47.12	107.95	60.33	29.00	58.00	87.00	12.00
1.181	30.00	48.72	111.13	63.50	29.00	58.00	87.00	12.00
1.250	32.00	50.31	111.13	63.50	29.00	58.00	87.00	12.00
1.375	35.00	53.50	111.13	66.68	29.00	58.00	87.00	12.00
1.500	38.00	56.68	127.00	71.93	29.00	58.00	87.00	12.00
1.575	40.00	58.28	127.00	71.93	29.00	58.00	87.00	12.00
1.625	42.00	59.87	127.00	71.93	29.00	58.00	87.00	12.00
1.750	43.0/45.0	63.05	133.35	76.76	29.00	58.00	87.00	12.00
1.875	46.0/48.0	66.24	133.35	76.76	29.00	58.00	87.00	12.00
2.000	50.00	69.42	139.70	86.00	29.00	58.00	87.00	12.00
2.125	53.00	72.60	146.05	93.65	29.00	58.00	87.00	16.00
2.165	55.00	74.19	146.05	93.65	29.00	58.00	87.00	16.00
2.250	58.00	75.78	146.05	93.65	29.00	58.00	87.00	16.00
2.375	60.00	78.97	152.40	100.00	29.00	58.00	87.00	16.00
2.500	63.00	83.74	177.80	109.52	29.00	58.00	87.00	16.00
2.625	65.00	86.92	177.80	109.52	29.00	58.00	87.00	16.00
2.750	70.00	90.10	177.80	109.52	29.00	58.00	87.00	16.00
2.875	73.00	93.27	177.80	125.40	29.00	58.00	87.00	16.00
3.000	75.00	96.45	190.50	125.40	29.00	58.00	87.00	16.00

Note: Additional technical & dimensional information will be provided on request