

Product Description

1. API 682 Category 2 and 3, Type A, Arrangement 3 seal
2. Dual seal in back-to-back configuration
3. Balanced design
4. Independent of direction of rotation
5. Cartridge construction
6. Pumping device available for increased efficiency in circulation
7. Rotary unit with multiple springs
8. Can accommodate reverse pressure

Technical Features

1. Can handle extensive applications in various temperatures and pressures
2. Versatile in design to fit various seal chambers
3. Material of construction available in special metallurgy
4. Special torque transmission design for high performance
5. Operation reliability due to rugged metal torque transmission at the rotating seal face

Industrial Application

- API 610/ISO 13709 pumps
- Oil and gas industry
- Refining technology
- Petrochemical industry
- Chemical industry
- Highly volatile hydrocarbons
- LPG plants
- Power plant technology
- Process pumps

Operating Limits

Shaft diameter: : d = 20 ... 110 mm
Pressure: p1 = ... 42 bar
Temperature: t = -40 °C ... +176 °C
Sliding velocity: vg == 23 m/s
Axial movement = ±1.5 mm

Note : Other Sizes On Request

Material Of Construction

Seal rings: Blister resistant carbon, Silicon carbide SSiC , RBSiC
Mating rings: Silicon carbide SSiC (Q1), RBSiC (Q2)
Secondary seals: EPDM (E), NBR (P), FKM (V), FFKM (K)
Springs: C-276 (M5)
Metal parts: CrNiMo steel 316 (G) or equivalent, optional materials on request.

Note : Other MOC Combinations On Request

Recommended Piping plans-2CW-CW

Process side*:
 01, 02, 03, 11, 12, 13, 14, 21, 22, 31, 32, 41
Between seals: 53A, 53B, 53C, 54
Atmospheric side:** 61, 62, 65A, 65B
 * Piping plans 11 ... 41:
 Integration in seal to be dimensionally checked.
 ** Throttle bushing on request.

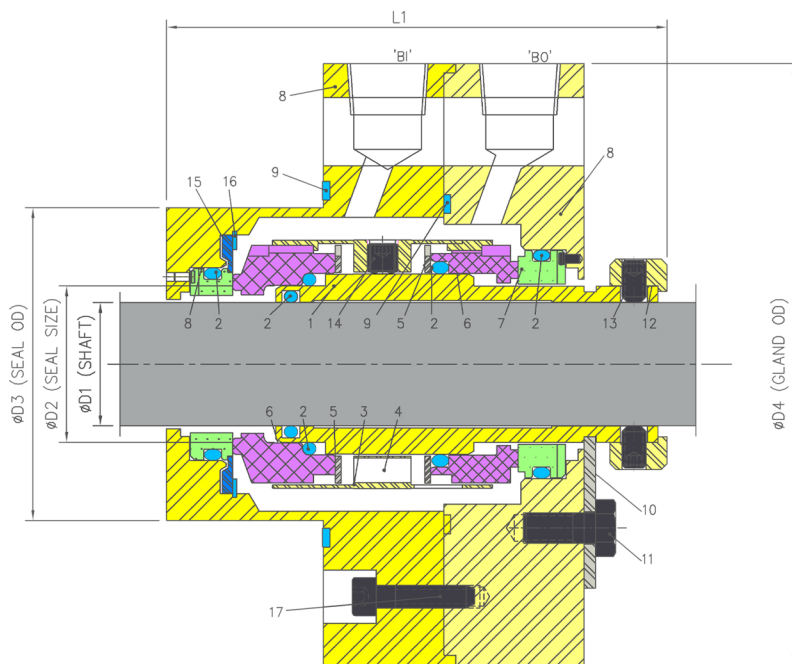

Item	Description
1	Sleeve
2	O- Ring
3	Cup
4	Spring
5	Thurst Washer
6	Seal ring(lb&Ob)
7	Mr(lb&Ob)
8,9	Gland(lb&Ob)
10	Centegring tab
11	Hex cap screw
12	Drive Collar
13,14	Soc set screw
15	Retaining ring
16	Circlip
17	Soc hD cap screw