

### Product Description

1. API 682 Category 2 and 3, Type A, Arrangement 2 seal
2. Dual seal in face-to-back configuration
3. Balanced design
4. Non contact outer seal (containment seal)
5. Cartridge construction
6. Rotating unit with multiple springs

### Technical Features

1. Suitable for both, retrofits and original equipment
2. Varied selection of materials available
3. Safe operation due to metal torque transmission at the rotating carbon seal rings

### Industrial Application

- API 610/ISO 13709 pumps
- Media with gaseous leakage
- Oil and gas industry
- Petrochemical industry
- Refining technology
- Process pumps

### Operating Limits

**Shaft diameter:** : d1 = 20 ... 110mm

**Pressure:** p1 = ... 42 (609) bar

**Temperature:** t = -40 °C ... +176°C

**Sliding velocity:** vg == 23 m/s

**Axial movement** = ±1.0mm

Note : Other Sizes On Request

### Material Of Construction

**Seal rings:** Blister resistant carbon, Silicon carbide SSiC , RBSiC

**Mating rings:** Silicon carbide SSiC (Q1), RBSiC (Q2)

**Secondary seals:** EPDM (E), NBR (P), FKM (V), FFKM (K)

**Springs:** : Hastelloy® C-276 (M5)

**Metal parts:** CrNiMo steel 316 (G) or equivalent, optional materials on request.

Note : Other MOC Combinations On Request

### Recommended Piping plans-2CW-CS

**Process side:** 01, 02, 03, 11, 12, 13, 14, 21, 22, 23, 31, 32, 41

**Between seals:** 71, 72, 75, 76

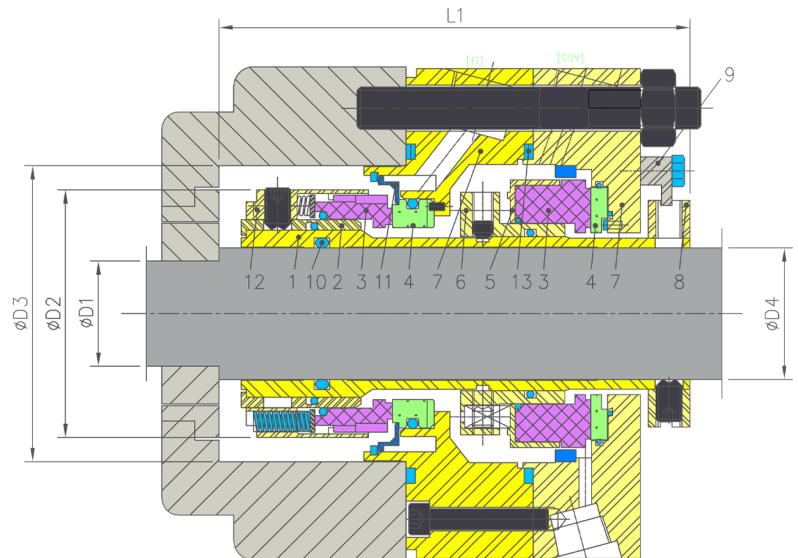

Item	Description
1	Sleeve
2	Aux Sleeve
3	Seal ring
4	Mr (ib& Ob)
5	Shell
6,12	Cup
7	Gland
8	Drive Collar
9	Locking plate
10	O ring
11	Retaining ring
13	Gasket