

Product Description

1. Double seal configuration.
2. Balanced Design
3. Cartridge Design construction
4. Equipment Specific Design

Technical Features

1. Stationary set of springs which are out of contact prevent clogging
2. Special double-balanced design allows the use of both pressurised and unpressurised seal water.
3. Drive is taken from the Impeller of the Screen.

Industrial Application

Paper and pulp industries
This seal is typically used in Pressure Screens and Pressure Thickeners

Material Of Construction

Seal Face: Carbon Graphite Antimony Impregnated/Carbon Graphite Resin Impregnated/Silicon - Carbide/Tungsten - Carbide

Seat : Carbon Graphite Antimony Impregnated Carbon Graphite Resin Impregnated/Silicon - Carbide/Tungsten -Carbide

Elastomer: Viton / Aflas / TTV / EPRM

Metal Parts: S.S.316 / Hast'C / Alloy C-276

Note : Other MOC Combinations On Request

Available Sizes

70mm,80 mm,95 mm,110 mm,
130 mm & 150 mm

Operating Limits

Pressure = 15 Kg/cm²)

Temperature = 180°C Max

Speed = 20m/s

Permissible axial movement = ±2.00mm

Suitable for equipment Models

Voith Pressure Screening Equipment

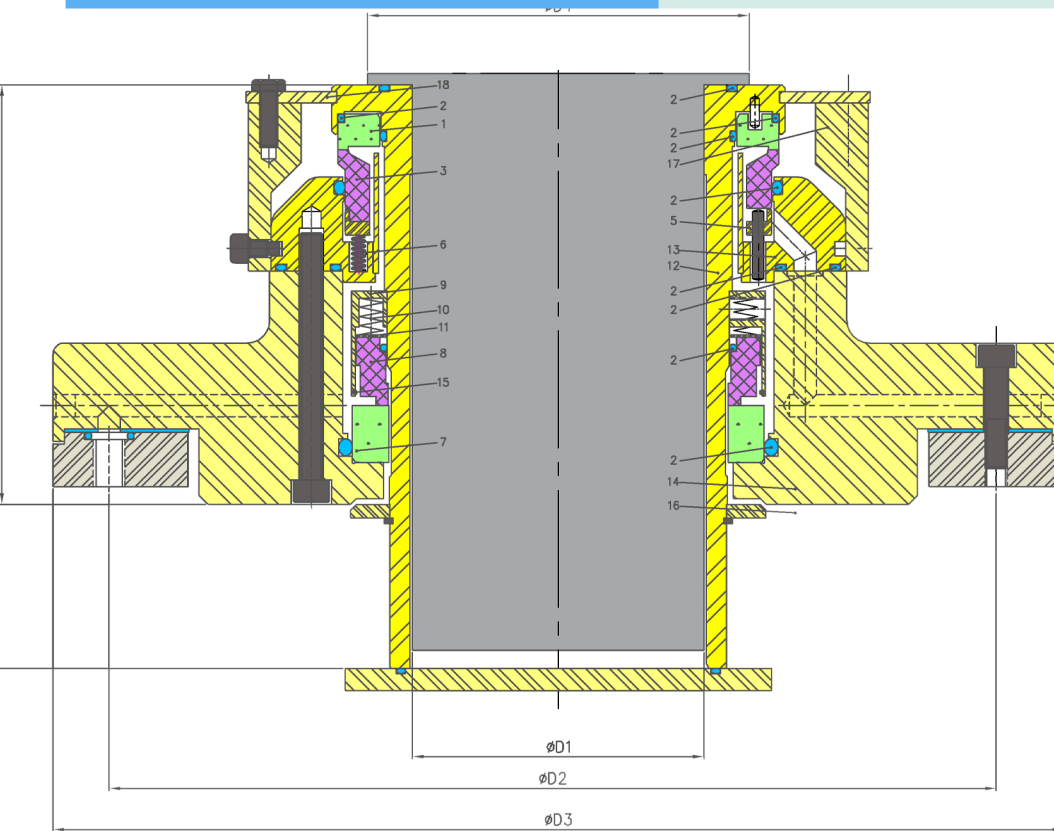

Item	Description
1,7	Mating ring
2	O ring
3,8	Seal ring IB&OB
5	Thrust ring
6,10	Spring
9	Cup

Item	Description
11	Thrust washer
12	Sleeve
13	Housing
14	Gland plate
15	Circlip
16	Restriction bush
17	Supporting ring
18	Sliding washer