

RJCS1-RJCS2 (Sulzer Alstar) Engineered Mechanical Seals



Product Description

1. Single & Double seal configuration available.
2. Balanced Design
3. Cartridge Design construction
4. Pump Specific Design

Technical Features

1. Heat Shrunken faces
2. Stationary set of springs which are out of contact prevent clogging
3. Milled anti-rotation slots prevent rolling of the body ring that protects the seal face. This eliminates tension peaks that would distort or break the seal face.
4. Special double-balanced design allows the use of both pressurised and unpressurised seal water.
5. The piston design permits free axial movement

Industrial Application

Paper and pulp industries
Effluent treatment plants
This seal is typically used in pumps for abrasive and environmentally hazardous liquids in cooking, evaporation, and causticising activities in pulp mills.

Material Of Construction

Seal Face: Carbon Graphite Antimony Impregnated/Carbon Graphite Resin Impregnated/Silicon - Carbide/Tungsten - Carbide
Seat : Carbon Graphite Antimony Impregnated/Carbon Graphite Resin Impregnated/Silicon - Carbide/Tungsten - Carbide
Elastomer: Viton / Aflas / TTV / EPDM
Metal Parts: S.S.316 / Hast'C / Alloy C-276
Note : Other MOC Combinations On Request

Available Sizes

30mm, 40 mm, 50 mm, 60 mm, 80 mm, 90 mm & 110 mm

Operating Limits

Pressure = 15 Kg/cm²
Temperature = 180°C Max
Speed = 20m/s
Permissible axial movement = ±2.00mm

Suitable for Pump Models

Sulzer Alstar Pump Series

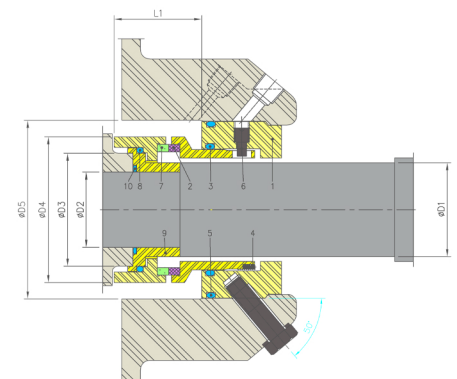
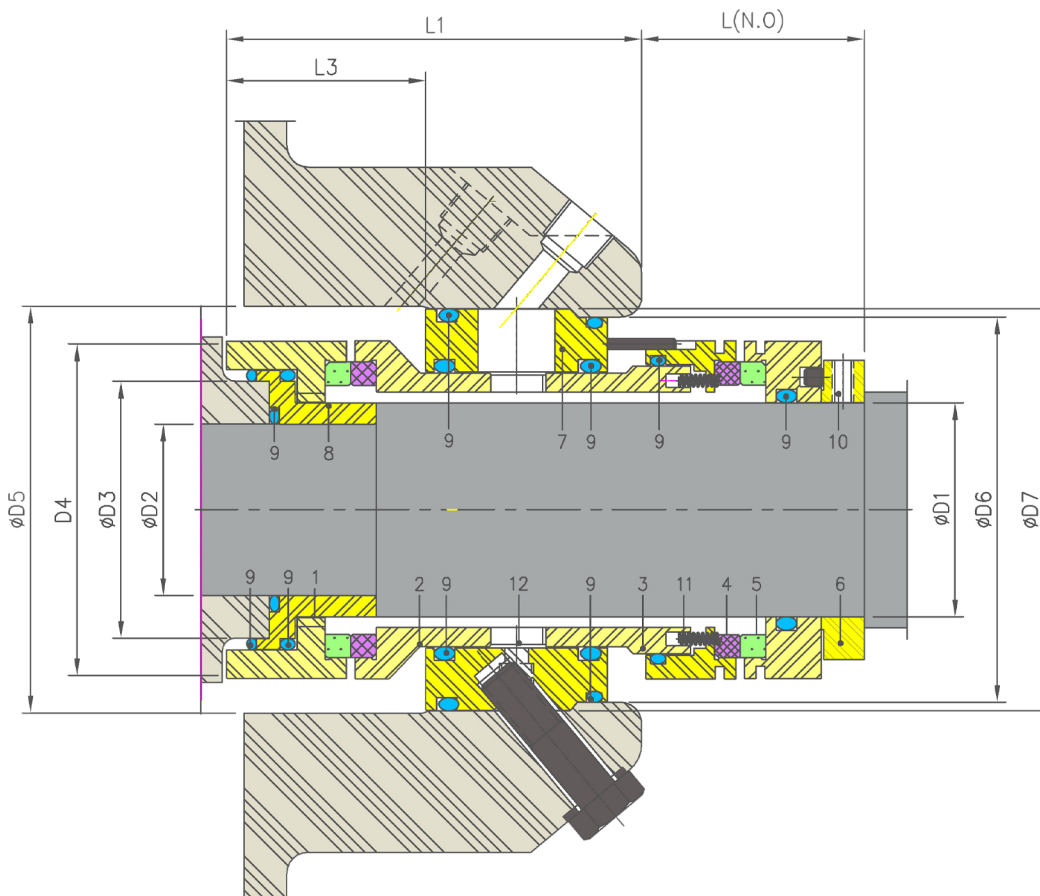

Item	Description
1,5	MR (IB&OB)
2,4	Seal ring
3	Pressure ring
6	Drive collar
7	Gland Plate
8	Intermediate Sleeve

Item	Description
9	O ring
10	Soc.Set screw
11	Spring
12	Dog pt screw