

GVSH/GVSHB

Glasslined Agitator Seals



Product Description

1. Top entry agitator seal
2. Compact and economical
3. Din standard pad details
4. Construction with integrated bearing also available

Technical Features

1. Factory assembled to ensure fast, easy installation and trouble free start up
2. T-type mating ring with two O rings takes care of vibrations and mis-alignments
3. No Dynamic O ring on Shaft

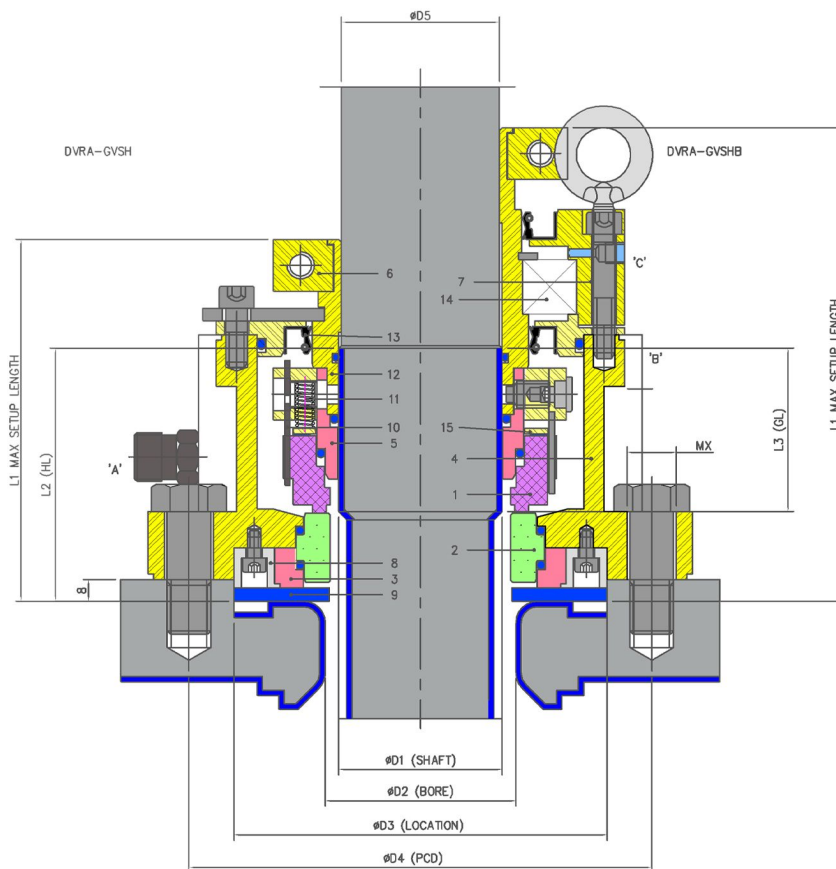

Industrial Application

Chemical industries
Pharmaceutical industries

Material Of Construction

Seal Face :Carbon Graphite Antimony Impregnated / Carbon Graphite Resin Impregnated / Silicon Carbide / Glass Filled Teflon
Seat: Carbon Graphite Antimony Impregnated / Carbon Graphite Resin Impregnated / Silicon-Carbide/ Tungsten-Carbide/Ceramic
Elastomer: Viton/Aflas/TTV/EPDM/KALREZ
Metal Parts: S.S.316 / Hast'C

Note : Other MOC Combinations On Request

Available Sizes

50mm to 160mm (2.000" to 6.000")

Note : Other Sizes On Request

Operating Limits

Pressure = Full vacuum to 12 Kg/cm2 (MAX)

Temperature = -40°C to 150°C

Speed = 300 rpm

Orientation

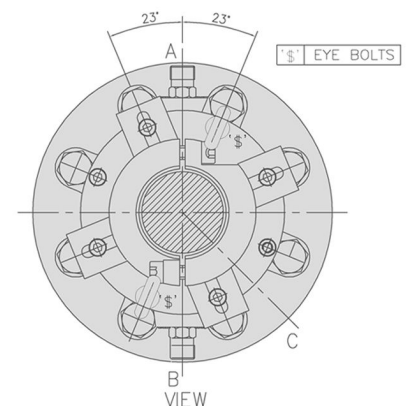

Connections:

"A & B" Barrier/Buffer Inlet and Outlet
"C" Grease Port

Item	Description
1	Seal ring
2	Mating Ring
3	Lock plate
4	Housing
5	Auxillary sleeve
6	Drive Collar

Item	Description
7	Bearing Block
8	Lock plate 2
9	Composite gasket
10	T - Bar
11	Spring
12	Sleeve

Item	Description
13	Oil Seal
14	Bearing
15	Thurust Washer

Installation, Details, Options

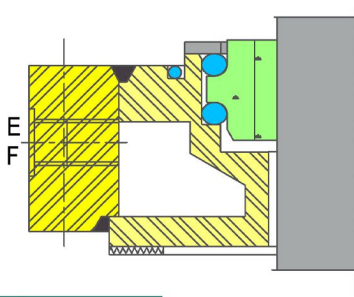

Option-1

Heat Trap Arrangement for Higher Temperature Applications

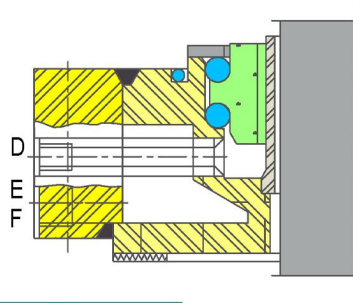

Option-2

Heat Trap Arrangement + Debris Collector Can be used for higher Temperature* for GMP

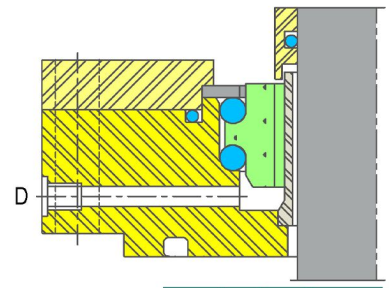

Option-3

Debris Collector Unit Can be used for GMP

Torque Transmissions

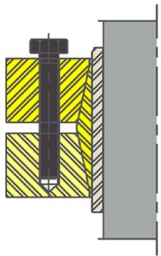

3-Piece Shrink Disk

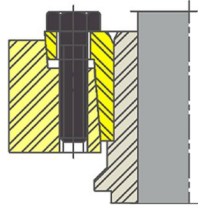

2-Piece Shrink Disk

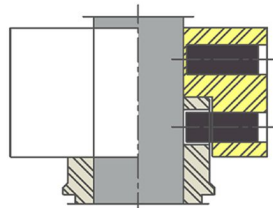

Double Row Set Screw Drive Collar

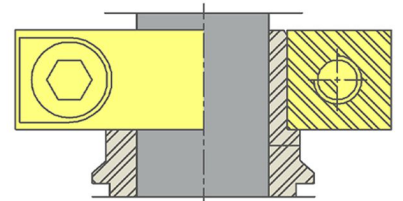

Split Collar

Dimensional Data

							L1	
D1	D2	D3	D4	D5	GVSH	GVSHB	MX	
40.00	50.00	114.00	145.00	38.00	130.00	165.00	M16	
50.00	60.00	126.00	155.00	48.00	135.00	170.00	M16	
60.00	70.00	137.00	170.00	58.00	130.00	165.00	M16	
80.00	90.00	167.00	200.00	78.00	155.00	200.00	M16	
100.00	110.00	203.00	270.00	98.00	155.00	205.00	M16	
125.00	135.00	220.00	295.00	120.00	165.00	230.00	M20	
140.00	150.00	313.00	350.00	135.00	160.00	235.00	M20	
160.00	170.00	313.00	350.00	150.00	170.00	230.00	M20	

Note: Additional technical & dimensional information will be provided on request